

# *Elevator*



## **WE1000**

The elevator was designed for easy operation. Featuring joystick controlled powered front wheel steering, the elevator is easy to position and maneuver without additional assistance. The operator is ideally positioned to monitor all functions.

The elevator features an 180-degree pivoting conveyor, to deliver load direction flexibility. The cylinder actuated chain drive provides precise and stable positioning.

A robust roading system was designed to make it easy to move the elevator between locations. Leveling feet, pivoting tow hitch, and a heavy duty axle with leaf spring suspension make it easy to attach to any capable truck for transport.

- ✓ **Self-propelled with retractable and steerable front drive axles**
- ✓ **Joystick control ground drive system**
- ✓ **Hydraulic actuated landing gear/lift legs**
- ✓ **Heavy-duty rear trailer axle**
- ✓ **Chain drive pivot with dual-acting cylinder**
- ✓ **Large, custom radiator and oil cooler package**
- ✓ **74hp John Deere engine**
- ✓ **Load cleaning blower fan**

## SPECIFICATIONS

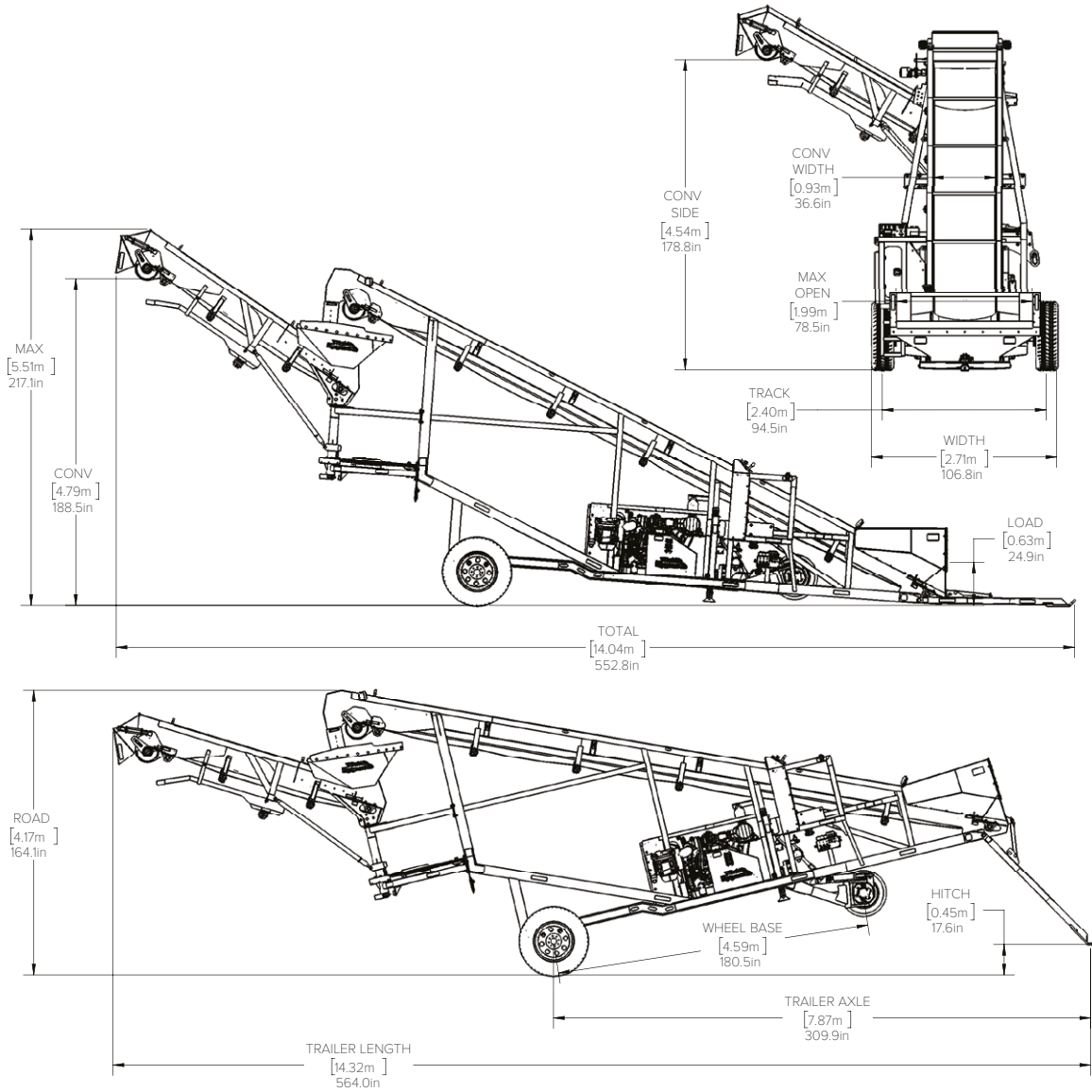

559-577-1800

OXBO.COM